



ULTIMATE

External Wall Insulation Systems

FIRE SAFE SOLUTIONS - keeping fire at bay



ULTIMATE SYSTEMS

Our Ultimate range of tested and approved systems utilise A1 non-combustible mineral wool or alternatively the innovative Fire Safe Composite (FSC) panel. The mineral wool based systems achieve industry leading fire ratings between A1 and A2-s1,d0, with compliance for use on high rise projects anywhere in the UK. The FSC systems attain a fire rating of B-s1,d0 and have also passed a full scale fire test in accordance with BS8414-1, behaving similar to mineral wool systems whilst offering the flexibility of an expanded polystyrene system. Ultimate systems are available in a variety of finishes and colours, providing designers with unparalleled architectural freedom achieved with a diverse colour palette and multiple textures. All systems have low water absorbency, which protects against the penetration of wind-driven rain, dirt and destructive chemicals within the atmosphere, also preventing failure from freeze-thaw.

Of equal importance is vapour permeability and durability, allowing the systems to breathe whilst protecting the system from day to day damage with a high level of impact resistance offered.

All the Ultimate silicone systems contain encapsulated biocides. These prevent the growth of algae and mould for longer periods than standard biocides, without affecting other technical performance parameters. This has been proven and demonstrated in Soltherm's on-site R&D centre, ensuring the paints and renders that arrive on your project are perfect for the environment they are to be used within.

ULTIMATE SILCONE

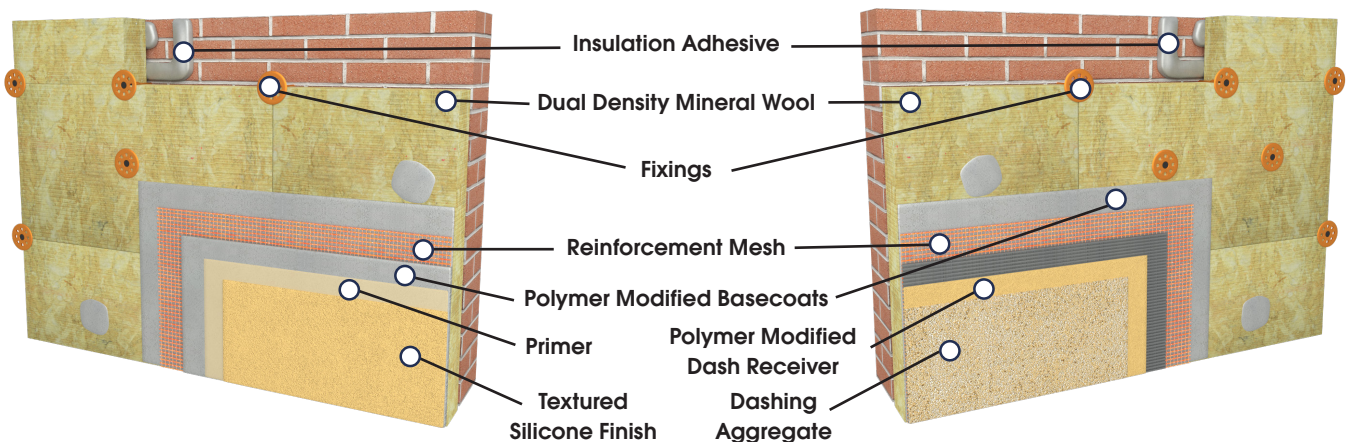

Insulation Adhesive

Soltherm only specify adhesive and mechanically fixed systems. This ensures the system has a better true-life fire performance as well as long life structural integrity and higher resistance to wind loads.

Dual Density Mineral Wool

Improved impact resistance.

Fixings

Only European Technically Approved mechanical fixings are utilised, offering superior mechanical performance whilst limiting the thermal transfer to nearly zero.

Reinforcement Mesh

Alkali resistant fibreglass mesh providing the system with flexibility and increased impact resistance.

ULTIMATE DASH

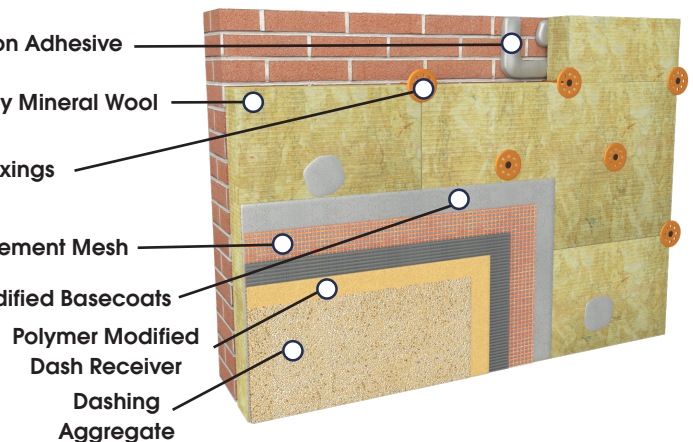

Polymer Modified Basecoats

Industry leading adhesive strength, workability and impact resistance.

Primer

Tinted to match the colour of the silicone textured finish, designed to improve adhesion and prevent pitting.

Polymer Modified Dash Receiver

Premium coloured dash receiving render formulated with excellent thixotropic properties ensuring it adheres to the dashing aggregate with no slumping effectively.

Textured Silicone Finish

Pure silicone plaster offering the diverse colour, algae resistance and flexibility.

Dashing Aggregate

Providing a colourful finish with high-end durability.

THE ULTIMATE RANGE

Title	Insulation	Finishes	Fire Performance	Description
Ultimate Dash	Mineral Wool	Soltherm SDR	A2-s1,d0	Dash finish system ideal for low and medium rise application where improved fire performance is desired.
Ultimate HD Dash	Mineral Wool	Soltherm SDR	A2-s1,d0	Dash finish system ideal high-rise applications due to its double mesh fixing technology.
Ultimate Silicone	Mineral Wool	Soltherm SFC-P 15 Soltherm SFC-P 20	A2-s1,d0	Silicone finish system ideal for low and medium rise applications where improved fire performance is desired.
Ultimate HD Silicone	Mineral Wool	Soltherm SFC-P 15 Soltherm SFC-P 20	A2-s1,d0	Silicone finish system ideal high-rise applications due to its double mesh fixing technology.
Ultimate A1 Mineral	Mineral Wool	Soltherm MTC 15* Soltherm MTC 20*	A1	Mineral painted finish system that is totally non-combustible (A1).
Ultimate FSC Dash	FSC	Soltherm SDR	B-s1,d0 BR135 Compliant	Innovative dash finish system ideal for low and medium rise application where improved fire performance is desired.
Ultimate FSC Silicone	FSC	Soltherm SFC-P 15 Soltherm SFC-P 20	B-s1,d0 BR135 Compliant	Innovative silicone finish system ideal for low and medium rise application where improved fire performance is desired.

*Requires additional silicone paint finish

FSC

FSC External Wall Insulation (EWI) system utilises a new advanced insulation, ensuring it is the safest and most economical solution of its type. The FSC panel demonstrates a significantly improved fire performance to that of conventional EPS.



SOLTHERM 4SEASONS

This is an additive that can be added to silicone finishes, providing enhanced wash off capabilities whilst also allowing the material to be applied at lower temperatures.



SOLTHERM STC-P

A silicone paint specifically designed use with Soltherm EWI systems. The paint has been devised to provide a coating to Soltherm EWI systems when they are looking tired. The paint will return the system to its initial vibrance, by using breathable and hydrophobic technology reinstating all the technical properties, further prolonging the effective life of the system and producing long lasting colours.





Soltherm External Insulation Ltd
Challenge House, Sherwood Drive
Bletchley, Milton Keynes MK3 6DP
Tel : 01908 533 444
www.ewi-soltherm.com

